

REV	DATE	REVISION DETAILS	APPD
更改号 日期		更改内容	审核并批准
①	2020.01.02	Production Issue	

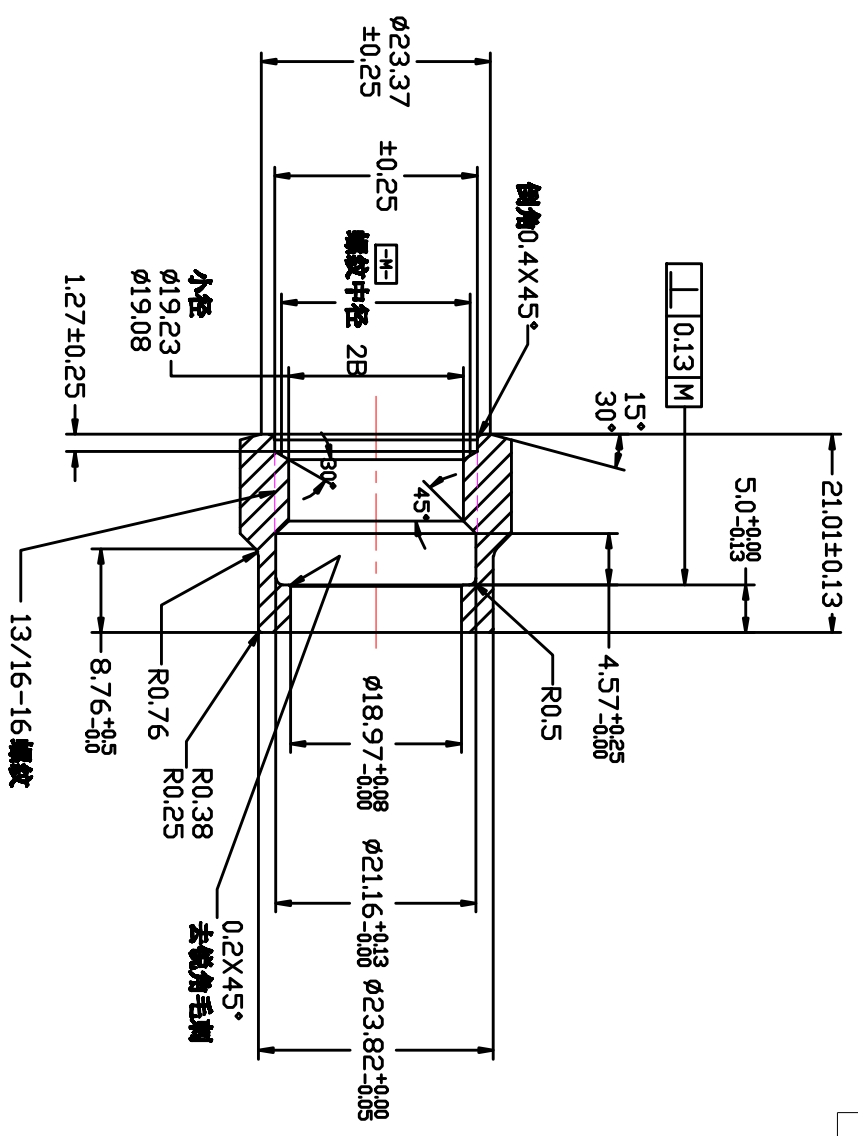

UNLESS SPECIFIED
ALL DIMENSIONS IN mm,
MACHINED SURFACES Ra=3.2um,
ANGLE TOLERANCES ±5°,
Other tolerances except angles,
in accordance with
GB/T1804-2000(ISO2768-1)-m
and GB/T1184-1996(ISO2768-2)-m

其它事项,
图示尺寸单位为mm,
未注机械加工表面粗糙度 Ra=3.2um,
未注角度公差 ±5°,
其它未注公差 (除角度外) 均按:
GB/T1804-2000(ISO2768-1)-m 和
GB/T1184-1996(ISO2768-2)-m

MATERIAL Chinese steel 45

FINISH

Remove all sharp edges,burrs,silvers and swarf, break all edges 0.127-0.254mm,
ZINC PLATING WITH 8um MICRONS MINIMUM PLATING THICKNESS AND TRIVALENT CHROMATE PASSIVATION
AND WITHSTAND 96 HRS TO WHITE / 144 HS TO RED RUST IN SALT SPRAY TEST
去除所有毛刺, 钝化所有锐角, 破边倒角0.127-0.254mm
镀锌, 三价铬钝化, 银白色, 盐雾试验96小时无红锈, 144小时无红锈, 镀锌层厚度大于70um

Zhejiang Gaocheng Autoparts Co.,Ltd	
PART NO 零件名	40597-8FS-8FS-SW-6PT -Swivel Nut
SCALE:	APPD:
DATE:	DATE:
DATE:	DATE:

SCALE:	DATE:	DATE:	DATE:
DATE:	DATE:	DATE:	DATE:
DATE:	DATE:	DATE:	DATE:
DATE:	DATE:	DATE:	DATE: